



Standard Flange Data

SLIP ON FLANGES	NOMINAL I.D.	WORKING PRESSURE RATING (PSIG) AT TEMPERATURE (DEG F)							
		(20) TO 100	200	300	400	500	600	700	800
CLASS 125 L.W. FORGED STEEL		175.00	152	134	116	98	80	62	46
AWWA 125 L.W. C207-54T CLASS D MATERIAL A-105	14" to 96"	150.0	131	115	99	82	67	51	38
CLASS 150 FORGED STEEL ANSI B16.5 MAT'L A-105	1" to 24"	285.00	260	230	200	170	140	110	80
CLASS 125 FORGED STEEL C207-54T CLASS E MAT'L A-105	26" to 96"	275.00	240	210	80	150	130	110	80
CLASS 300 FORGED STEEL ANSI B16.5 MAT'L A-105	1" to 24"	740.00	675	655	635	600	550	535	410
CLASS 400 FORGED STEEL ANSI B16.5 MAT'L A-105	1" to 24"	990.00	900	875	845	800	730	710	550

SIZE INCH	CLASS 125 LW							CLASS 150 B16.5							CLASS 300 B16.5							SIZE INCH			
	OD	T	L	BC	#H	HD	WT (LBS)	OD	T	L	BC	#H	HD	WT (LBS)	OD	T	L	BC	#H	HD	WT (LBS)				
1-1/2"								5	11/16	7/8	3 7/8	4	5/8	3	6 1/8	13/16	1 3/16	4 1/2	4	7/8	6	1-1/2"			
2								6	3/4	1	4 3/4	4	3/4	5	6 1/2	7/8	1 5/16	5	8	3/4	7	2			
2-1/2"								7	7/8	1 1/8	5 1/2	4	3/4	7	7 1/2	1	1 1/2	5 7/8	8.8	7/8	10	2-1/2"			
3								7 1/2	15/16	1 3/16	6	4	3/4	8	8 1/4	1 1/8	1 11/16	6 5/8	8	7/8	13	3			
3-1/2"								8 1/2	15/16	1 1/4	7	4	3/4	11	9	1 3/16	1 3/4	7 1/4	8	7/8	17	3-1/2"			
4								9	15/16	1 5/16	7 1/2	8	0.75	13	10	1 1/4	1 7/8	7 7/8	8	7/8	22	4			
5								10	15/16	1 7/16	8 1/2	8	0.875	15	11	1 3/8	2	9 1/4	8	7/8	28	5			
6	11	9/16	1 1/4	9 1/2	8	7/8	13	11	1	1 9/16	9 1/2	8	0.875	19	12 1/2	1 7/8	2 1/16	10 5/8	12	7/8	39	6			
8	13 1/2	9/16	1 1/4	11 3/4	8	7/8	18	13 1/2	1 1/8	1 3/4	11 3/4	8	0.875	30	15	1 5/8	2 7/16	13	12	1	58	8			
10	16	11/16	1 1/4	14 1/4	12	1	26	16	1 3/16	1 15/16	14 1/4	1	1	43	17 1/2	1 7/8	2 5/8	15 1/4	16	1 1/8	81	10			
12	19	11/16	1 1/4	17	12	1	42	19	1 1/4	2 3/16	17	12	1	64	20 1/2	2	2 7/8	17 3/4	16	1 1/4	115	12			
14	21	3/4	1 1/4	18 3/4	12	1 1/8	44	21	1 3/8	2 1/4	18.75	12	1 1/8	90	23	2 1/8	3	20 1/4	20	1 1/4	165	14			
16	23 1/2	3/4	1 1/4	21 1/4	16	1 1/8	58	23 1/2	1 7/16	2 1/2	21.25	16	1 1/8	98	25 1/2	2 1/4	3 1/4	22 1/2	20	1 3/8	190	16			
18	25	3/4	1 1/4	22 3/4	16	1 1/4	59	25	1 9/16	2 11/16	22.75	16	1 1/4	130	28	2 3/8	3 1/2	24 3/4	24	1 3/8	250	18			
20	27 1/2	3/4	1 1/4	25	20	1 1/4	69	27 1/2	1 11/16	2 7/8	25	20	1 1/4	165	30 1/2	2 1/2	3 3/4	27	24	1 3/8	315	20			
22	29 1/2	1	1 3/4	27 1/4	20	1 3/8	76	29 1/2	1 13/16	3 1/8	27.25	20	1 3/8	185	33	2 5/8	4	29 1/4	24	1 5/8	370	22			
24	32	1	1 3/4	29 1/2	20	1 3/8	115	32	1 7/8	3 1/4	29.5	20	1 3/8	220	36	2 3/4	4 3/16	32	24	1 5/8	475	24			
26	34 1/4	1	1 3/4	31 3/4	24	1 3/8	125	CLASS 125																	
28	36 1/2	1	1 3/4	34	28	1 3/8	140	36 1/2	1 1/16	3 7/16	34	28	1 3/8	270											
30	38 3/4	1	1 3/4	36	28	1 3/8	150	38 3/4	1 1/8	3 1/2	36	28	1 3/8	305											
32	41 3/4	1	1 3/4	38 1/2	28	1 5/8	205																		
34	43 3/4	1 1/8	1 3/4	40 1/2	32	1 5/8	215																		
36	46	1 1/8	1 3/4	42 3/4	32	1 5/8	235	46	2 3/8	3 3/4	42 3/4	32	1 5/8	450											
38	48 3/4	1 1/8	1 3/4	45 1/4	32	1 5/8	250																		
40	50 3/4	1 1/8	1 3/4	47 1/4	36	1 5/8	280																		
42	53	1 1/8	1 3/4	49 1/2	36	1 5/8	330	53	2 5/8	4	49 1/2	36	1 5/8	650											
48	59 1/2	1 3/8	2 1/2	56	44	1 5/8	425	59 1/2	2 3/4	4 1/8	56	44	1 5/8	800											
54	66 1/4	1 3/8	2 1/2	62 3/4	44	1 7/8	500	66 1/4	3	4 3/8	62 3/4	44	1 7/8	1025											
60	73	1 1/2	2 3/4	59 1/4	52	1 7/8	640	73	3 1/8	4 1/2	69 1/4	52	1 7/8	1250											
66	80	1 1/2	2 3/4	76	52	1 7/8	750	80	3 3/8	4 7/8	76	52	1 7/8	1775											
72	86 1/2	1 1/2	2 3/4	82 1/2	60	1 7/8	850	86 1/2	3 1/2	5	82 1/2	60	1 7/8	1925											
84	99 3/4	1 3/4	3	95 1/2	64	2 1/8	1000	99 3/4	3 7/8	5 3/8	95 1/2	64	2 1/8	2600											
96	113 1/4	2	3 1/4	108 1/2	68	2 3/4	1650	113 1/4	4 1/4	5 3/4	108 1/2	68	2 3/8	3275											

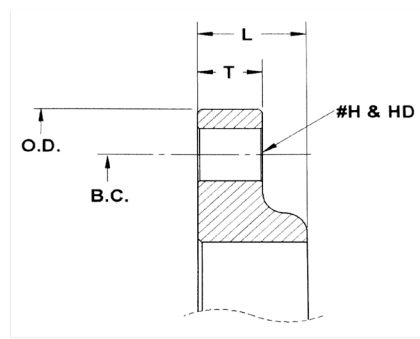



Plate Flanges

150 # Drilling Flange Plate Flange Dimensions							FF OAL Adjust Catalog Pressure	
Nominal Pipe Size	OD (inch)	Thickness (inch)	Bolt Circle (inch)	# of Holes	Hole Diameter (inch)	Wt. (Lbs.)	50	150
2	6	5/8	4 3/4	4	3/4	4	- 3/4	- 3/4
2 1/2	7	5/8	5 1/2	4	3/4	5	-1	-1
3	7 1/2	5/8	6	4	3/4	6	-1 1/8	-1 1/8
3 1/2	8 1/2	5/8	7	8	3/4	8	-1 1/4	-1 1/4
4	9	5/8	7 1/2	8	3/4	8	-1 3/8	-1 3/8
5	10	3/4	8 1/2	8	7/8	11	- 1/2	- 1/2
6	11	3/4	9 1/2	8	7/8	12	- 3/8	- 3/8
8	13 1/2	1	11 3/4	8	7/8	23	- 1/4	- 1/4
10	16	1	14 1/4	12	1	30	- 1/8	- 1/8
12	19	1	17	12	1	43	- 5/8	- 5/8
14	21	1	18 3/4	12	1 1/8	63	0	-2
16	23 1/2	1 1/4	21 1/4	16	1 1/8	76	0	-2 1/2
18	25	1 1/4	22 3/4	16	1 1/4	90	1/2	5/8
20	27 1/2	1 1/2	25	20	1 1/4	106	1/2	-1
22	29 1/2	1 1/2	27	20	1 3/8	120	1/2	-1 1/2
24	32	1 1/2	30	20	1 3/8	133	1/2	-3 1/2
300 # Drilling Flange Plate Flange Dimensions							FF OAL Adjust Catalog Pressure	
Nominal Pipe Size	OD (inch)	Thickness (inch)	Bolt Circle (inch)	# of Holes	Hole Diameter (inch)	Wt. (Lbs.)	300	
2	6 1/2	1	5	8	3/4	7	- 5/8	
2 1/2	7 1/2	1	5 7/8	8	7/8	9	-1	
3	8 1/4	1	6 5/8	8	7/8	11	-1 3/8	
3 1/2	9	1	7 1/4	8		15	-1 1/4	
4	10	1	7 7/8	8	7/8	19	-1 1/2	
5	11	1 1/4	9 1/4	8		24	-1 1/2	
6	12 1/2	1 1/2	10 5/8	12	7/8	34	-1 1/8	
8	15	1 1/2	13	12		49	-1 7/8	
10	18	1 3/4	15 1/4	16	1	66	-1 3/4	
12	20 1/2	2	17 3/8	16	1 1/8	102	-1 3/4	
14	23	2	20 1/4	20	1 1/4	132	-2	
16	25 1/2	2 1/4	22 1/2	20	1 1/4	175	-2	
18	28	2 1/2	24 3/4	24	1 3/8	226	-2	
20	30 1/2	2 1/2	27	24	1 3/8	265	-2 1/2	
22	33	2 3/4	29	24	1 5/8	326	-2 1/2	
24	36	2 3/4	32	24	1 5/8	394	-2 7/8	



Angle Flanges

						BOLT HOLES		
Nominal Diameter (inch)	Actual IS (inch)	Angle Thickness "T" (inch)	Angle Height	Angle Length	Approx. Weight (Lbs.)	Bolt Circle (Inch)	Hole Size (Inch)	No. of Holes
14	14 3/8	3/16	1 1/2	1 1/2	7	15 3/8	13/32	12
16	16 1/4	3/16	1 3/4	1 3/4	9.5	18 1/8	13/32	16
18	18 1/4	3/16	1 3/4	1 3/4	10.5	20 1/8	13/32	16
20	20 1/4	3/16	1 3/4	1 3/4	11.6	22 3/20	13/32	20
22	22 1/4	3/16	1 3/4	1 3/4	12.8	24 1/8	9/16	20
24	24 1/4	3/16	1 3/4	1 3/4	14	26 1/8	9/16	20
26	26 1/4	3/16	2	2	17.3	28 1/2	9/16	24
28	28 1/4	3/16	2	2	18.5	30 1/2	9/16	24
30	30 1/4	3/16	2	2	20	32 1/2	9/16	28
32	32 1/4	3/16	2	2	21.3	34 1/2	9/16	28
34	34 1/4	3/16	2	2	22.5	36 1/2	9/16	32
36	36 1/4	3/16	2	2	23.8	38 1/2	9/16	32
38	38 1/4	3/16	2	2	24.6	40 1/2	9/16	36
40	40 1/4	3/16	2	2	26.2	42 1/2	9/16	36
42	42 1/4	3/16	2	2	27.5	44 1/2	9/16	40
44	44 1/4	3/16	2	2	28.8	46 1/2	9/16	40
46	46 1/4	3/16	2	2	30	48 1/2	9/16	44
48	48 1/4	3/16	2	2	31.5	50 1/2	9/16	44
50	50 1/4	1/4	3	3	54	53 1/2	11/16	48
52	52 1/4	1/4	3	3	57	55 1/2	11/16	48
54	54 1/4	1/4	3	3	59.7	57 1/2	11/16	52
60	60 1/4	1/4	3	3	68.2	63 1/2	11/16	56
66	66 1/4	1/4	3	3	76.7	69 1/2	11/16	60
72	75 5/16	3/8	3	3	119.3	75 1/2	11/16	68
84	84 5/16	3/8	3	3	141.9	87 1/2	13/16	76
96	96 5/16	3/8	3	3	164.5	99 1/2	13/16	88
108	108 3/16	3/8	3	3	187.3	111 1/2	13/16	100
120	120 3/8	3/8	3	3	209.9	123 1/2	13/16	108
132	132 3/8	3/8	3	3	232.5	135 1/2	13/16	120
144	144 3/8	3/8	3	3	255.1	147 1/2	13/16	132